



**Celebrating 25 Years**  
Together, we engineer a better world.



# HSL WATERFRONT @ PENJURU



# ASIA

# Infrastructure Construction

**Our  
Business in  
brief**

**We build ports, roads and bridges, and help bring clean water and electricity to communities.**



# QUICK FACTS

---

**Founded in  
1994**

**20** times  
Increase in turnover  
in 10 years

**\$17m to \$350m**  
(2007 & 2017)

**1000 employees  
> 10 nationalities**



# BUSINESS SEGMENTS

---





# 30MGD Desalination Plant

# Singapore

**BUSINESS OWNER** Water  
Public Utilities Board, Singapore  
**YEAR** 2015

**PROCESS DESIGN PARTNER** Tedagua S.P.a.



# 44MGD Water Reclamation Plant

# Singapore

**BUSINESS OWNER** Water  
Public Utilities Board, Singapore  
**YEAR** 2017

**ENGINEERING PARTNER**

**Mott MacDonald**



# 13,500m<sup>3</sup>/Day Sewage Treatment Plant Singapore

<b>BUSINESS OWNER</b>	Environment Public Utilities Board, Singapore	<b>PROCESS DESIGN PARTNER</b>	ACE Water & Nanyang Environment & Water Research Institute (NEWRI)
<b>YEAR</b>	2015		



# Industrial Waste Water Pre-Treatment Plant      Singapore

**BUSINESS** Environment  
**CLIENT** Jurong Aromatics Corporation, Singapore  
**YEAR** 2012

**TECHNOLOGY PARTNER** Hitachi Plant Technologies



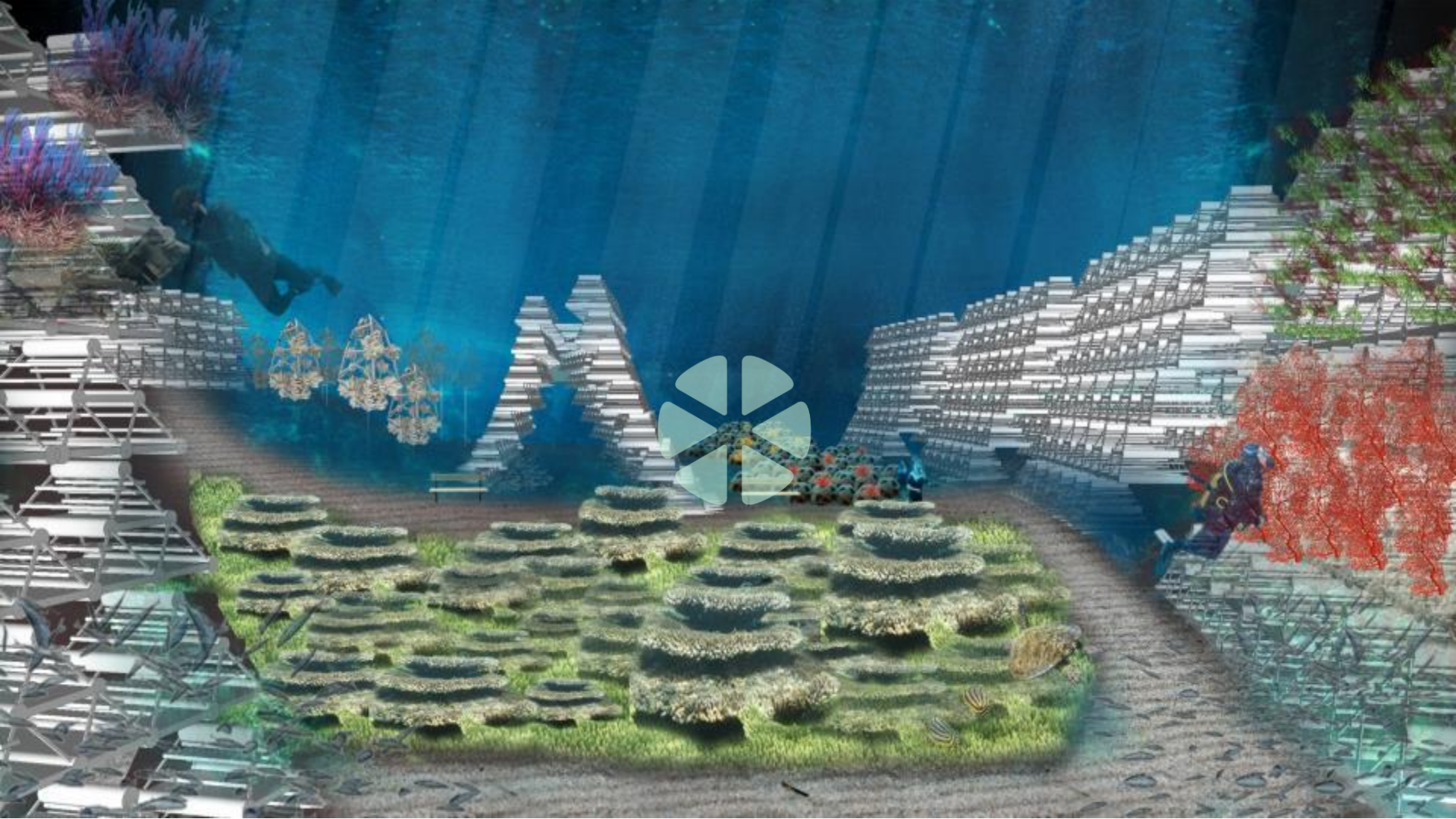

## Artificial Reef

## Singapore

**BUSINESS** Environment  
**CLIENT** JTC Corporation  
**YEAR** 2017

**DESIGN PARTNER** National University of Singapore



# 240,000m<sup>3</sup> Naphtha Tank Farm

# Singapore

**BUSINESS** Energy  
**CLIENT** Petrochemical Corporation of Singapore  
**YEAR** 2015

**JV PARTNER** JGC Singapore





# 2,000MW Coal-Fired Power Plant

# Malaysia

**BUSINESS** Energy  
**OWNER** Tenaga Nasional Berhad  
**YEAR** 2016

**MAIN CONTRACTOR** IHI – TOSHIBA – HYUNDAI  
Consortium



# LNG Re-Gasification Terminal

# Malaysia

**BUSINESS OWNER** Energy  
Petroliam Nasional Berhad (Petronas)  
**YEAR** 2015

**MAIN CONTRACTOR** Samsung C & T



# 2,242MW CCGT Power Plant

# Malaysia

**BUSINESS** Energy  
**OWNER** EDRA Engineering  
**YEAR** 2018

**MAIN CONTRACTOR** Hyundai Engineering



## Coal Unloading Jetty

## Malaysia

**BUSINESS** Sea Ports & Jetties  
**OWNER** Tanjung Bin Energy Sdn Bhd  
**YEAR** 2017

**MAIN CONTRACTOR** HSL – TecGates – GEMA  
Consortium



# Tanjung Priok Port

# Indonesia

**BUSINESS** Sea Ports & Jetties  
**OWNER** Pelindo II  
**YEAR** 2013

**MAIN CONTRACTOR** PT. Pembangunan  
Perumahan (Pesero) Tbk



# Denko Thilawa Terminal

# Myanmar

**BUSINESS** Sea Ports & Jetties  
**CLIENT** Denko Petrochemical Management Co., Ltd  
**YEAR** 2017

**DESIGN PARTNER** Surbana Jurong





# 5KM Underground Expressway

# Singapore

**BUSINESS** Land Transport  
**OWNER** Land Transport Authority, Singapore  
**YEAR** 2010

**MAIN CONTRACTOR** Hock Lian Seng

# RECENT HUMANITARIAN AID



**1. Provided clean water in Chennai, Kelantan, & Nepal**

**2. Reconstruction of Children's Orphanage in Nepal**

**3. Distributed Hygiene Kits, Food & Medical Supplies in Aceh**

# GET IN TOUCH



**Global Head Office:**  
**HSL Constructor Pte Ltd**  
**HSL Waterfront@Penjuru**  
**42D Penjuru Road**  
**Singapore 609162**  
**T +65 6898 5225**  
**F +65 6898 5156**  
**E [info@hsl.com.sg](mailto:info@hsl.com.sg)**  
**[www.hsl.com.sg](http://www.hsl.com.sg)**

**Regional Head Office:**  
**HSL Constructor Sdn Bhd**  
**No. 90-3A Jalan Era Square 7**  
**Era Square, 70200 Seremban**  
**Negeri Sembilan, Malaysia**  
**T +606-760 6928**  
**F +606-760 6918**  
**E [info@hsl-international.com](mailto:info@hsl-international.com)**

**SINGAPORE | MALAYSIA | INDONESIA | MYANMAR | INDIA | VIETNAM**  
**[www.hsl-international.com](http://www.hsl-international.com)**

# OUR GEOGRAPHICAL FOOTPRINT

